

PVC-U/C VANSTONE FLANGE

活套平承法兰, PVC-U/C (国标, 美标)

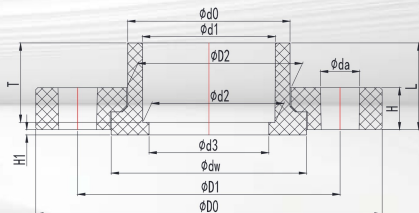

产品参数 (国标 DIN)

尺寸 Size DN	外形尺寸 Dimensions (mm)													公称压力 Nominal Pressure PN(kg/cm ²)	
	D0	D1	D2	d0	d1	d2	d3	dw	da	T	H1	H	L		螺孔数 n
15	95.00	65.00	31.00	30.50	20.30	19.95	16.00	37.60	14.00	23.22	2.50	13.00	24.70	4	PN16
20	105.00	75.00	37.90	36.90	25.35	24.95	20.60	47.00	14.00	26.40	2.50	14.00	27.90	4	PN16
25	115.00	85.00	45.70	44.70	32.35	31.95	27.00	56.00	14.00	29.58	2.50	15.00	31.08	4	PN16
32	140.00	100.00	55.00	54.00	40.40	39.95	36.00	64.00	18.00	32.75	2.50	15.00	35.25	4	PN16
40	150.00	110.00	62.60	61.60	50.35	49.90	45.00	74.00	18.00	31.20	2.50	18.00	33.70	4	PN16
50	165.00	125.00	78.40	77.40	63.40	62.90	57.00	93.00	18.00	37.70	2.50	20.00	41.20	4	PN16
65	185.00	145.00	91.40	90.40	75.40	74.90	69.00	110.00	18.00	43.70	2.50	23.00	47.20	4	PN16
80	200.00	160.00	107.50	106.50	90.50	89.90	83.00	126.00	18.00	51.20	2.50	26.00	55.70	8	PN16
100	220.00	180.00	127.90	126.90	110.60	109.90	103.00	147.00	18.00	61.20	2.50	28.00	65.70	8	PN16
De125	250.00	210.00	145.00	144.00	125.70	124.90	117.00	164.00	18.00	68.70	2.50	29.00	74.20	8	PN16
125	250.00	210.00	162.30	161.30	140.75	139.90	131.50	181.00	18.00	76.20	2.50	30.00	81.70	8	PN16
150	285.00	240.00	186.30	184.30	160.80	159.90	151.00	204.00	22.00	86.20	3.00	32.00	92.20	8	PN16
De180	340.00	295.00	229.00	227.00	201.00	199.90	190.00	257.40	22.00	106.20	3.00	36.00	112.20	8	PN10
De200	340.00	295.00	256.10	254.10	226.20	224.90	216.00	271.00	22.00	119.10	3.00	38.00	127.70	8	PN10
200	395.00	350.00	283.30	281.30	251.30	249.90	239.50	310.00	22.00	131.65	3.50	40.00	138.20	12	PN10
De250	398.00	351.50	308.00	305.50	281.50	280.15	272.00	325.00	22.00	147.00	10.00	35.00	159.00	12	PN10
300	445.00	400.00	356.60	354.60	316.70	314.90	302.00	373.00	22.00	167.70	5.00	44.00	175.70	12	PN10
350	510.00	450.00	393.00	391.00	356.80	355.00	326.00	417.00	24.00	184.30	32.00	40.00	197.00	16	PN10
400	570.00	500.00	444.00	442.00	402.00	400.00	369.80	453.00	24.00	204.20	40.00	44.00	226.00	16	PN10
De450	620.00	565.00	488.50	486.00	451.94	450.05	447.00	518.00	27.00	233.00	38.00	45.00	245.00	20	PN10
De500	670.00	620.00	541.00	536.50	502.80	500.60	596.00	573.00	27.00	257.40	38.00	50.00	268.00	20	PN10

产品参数 (美标 ASTM SCH80)

尺寸 Size (*")	外形尺寸 Dimensions (mm)													螺孔数 n
	D0	D1	D2	d0	d1	d2	d3	dw	da	T	H1	H	L	
1/2"	89	61	31	30.5	21.54	21.23	16	37.6	16	23.22	2.5	13	24.72	4
3/4"	98	70	37.9	36.9	26.87	26.57	20.6	47	16	26.4	2.5	14	27.9	4
1"	108	79	45.7	44.7	33.66	33.27	27	56	16	29.58	2.5	15	31.08	4
1-1/4"	117	89	55	54	42.42	42.04	36	64	16	32.75	2.5	15	35.25	4
1-1/2"	127	98	62.6	61.6	50.46	50.46	45	72.4	16	35.93	2.5	18	38.43	4
2"	152	121	74.1	73.1	60.63	60.17	52.5	88.5	19	39.1	2.5	20	42.6	4
2-1/2"	178	140	89.4	88.4	73.38	72.85	65	108	19	45.5	2.5	23	49	4
3"	191	152	106.3	105.3	89.31	88.7	80	124.8	19	48.63	2.5	26	53.13	4
4"	229	191	133	132	114.76	114.07	102	152	19	58.15	2.5	28	62.65	8
5"	254	216	162.9	161.9	141.81	141.04	122	181.5	22	68	2.5	30	73.5	8
6"	284	241	192.5	191.5	168.83	168	150	209.5	22	77.2	3	32	83.2	8
8"	343	298	247.9	246.9	219.84	218.69	193	264.9	22	102.6	3	36	108.6	8
10"	410	362	309.8	305.8	273.81	272.67	262.5	327.37	24	128	3	42	138	12
12"	482.6	432	366.6	362.6	324.6	323.47	313	384.60	24	153.4	3	44	166	12
14"	534	476.3	402	399.2	356.6	355.5	331.5	426.6	28.6	183.5	3	52	186	12
16"	600	540.8	456	451.6	407.6	406.36	342.5	482.4	28.6	208	3	60	210	16